



## SHORFAST

Symons shoring and deck support systems are engineered for maximum strength, labor productivity and reuse capabilities.

The aluminum ShorFast shoring system components feature high strength-to-weight ratios. Most components are light enough to be carried by one person, yet because of their strength, fewer pieces are needed. Less time and labor are required for set up and removal.

## SHORFAST SYSTEM COMPONENTS

### **ShorFast™ Leg Assembly**

The ShorFast legs are manufactured entirely from aluminum. The body is extruded with four large keyways to accept ShorFast Frames and provides a positive rigid connection. The top and bottom plates are aluminum castings with four bolt holes to enable legs to be bolted together and a center hole to accept the ShorFast Jack.



Size		Weight	
m	ft-in	kg	lbs
0.5	1'-8"	4	8.8
1.5	4'-11"	10	22.0
2.0	6'-7"	13	28.6
2.5	8'-2"	17	36.2

### **Jacks**

The ShorFast Jacks are manufactured entirely from aluminum. The collar has a self cleaning thread to enable adjustment to be made easily. The base casting has location holes to accept Trigger Braces to be fitted to the ShorFast Frames where required.

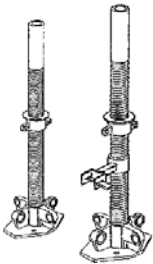

Size		Weight		Range
m	ft-in	kg	lbs	in
1.1	43"	8.0	17.6	5"-32"
1.6	63"	11.7	23.3	7"-52"

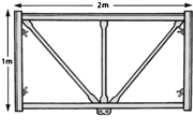

### **Frames**

The ShorFast Frames are manufactured entirely from aluminum. The side members are extruded with a location key that fits neatly into the ShorFast Leg to give a positive and rigid connection. They are secured to the leg using four "T" nuts and hand tightened via a large cast collar. The top member is an Omega (W) shaped extrusion to enable suitable boards to set on top for access and edge beams.

Size		Weight	
m	ft-in	kg	lbs
1.0	3'-3"	9.0	19.8
2.0	6'-7"	13.0	28.6
3.0	9'-10"	15.5	34.1

### **Deck Platform**



Deck Platforms provide a secure working platform. They are available in 2m and 3m lengths. Each platform has spring-loaded hooks to secure them to the ShorFast Frames. Fixing Brackets secure 1.90 O.D. pipe to the ShorFast legs to provide guardrail protection.

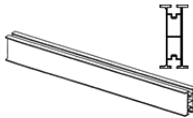

### **ShorFast Beam**

The ShorFast Beam is a 22.5cm (87/8") deep extruded aluminum stringer. The beam weighs 6.4kg/m (4.27lbs/ft). Beams are secured to the legs of jacks with a light beam clip that connects in the groove of the beam. The light weight and high capacity of the beam further enhances the productivity of this system.

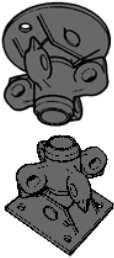

### **Trigger Braces**

Trigger Braces decrease the effective lengths of the legs and therefore increase their safe load carrying capacity. The trigger locking mechanism allows them to be attached or removed quickly, without the need for loose bolts and nuts.

### **Sloping Adapter Units**

Two sloping units are available for the ShorFast system; the Sloping Head Unit and the Sloping Base Unit. Each of these units can accommodate a sloped surface up to 30° from horizontal without the need for wood wedges.



### **Spanner**

The ShorFast Spanner facilitates easy release of the Screw Jacks. The spanner can be used as it is up to 97kN (22kips). From 97kN (22kips) to 133kN (30kips), a 90cm (3ft) length of pipe can be slipped over the spanner handle.



## SHORFAST CAPACITIES

### Capacity

When used as a stand-alone post shore, ShorFast legs have a maximum capacity of 111kN (25kips) at a 3:1 safety factor.

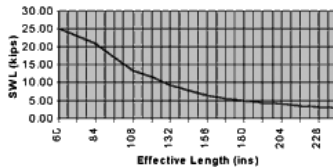

When used in tower configurations with ShorFast Frames and Trigger Braces, a 133kN (30kip) capacity at a 2.5:1 safety factor can be achieved.

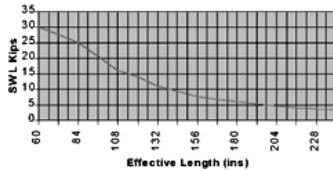

### ShorFast Rolling Tables

ShorFast tables can easily be flown or rolled from pour to pour. High capacity aluminum legs and jacks provide efficient support spacings. Wheel assemblies may remain in place or move easily from table to table.

### Wheel Assemblies

The Wheel Assemblies are available in two sizes to match the 1.1m or 1.6m jacks. The top of each assembly is connected to the ShorFast leg with the attached T-nut collar assembly. The bottom is quickly connected to the jack with a pin and clip.

### Jack Retainer

The Jack Retainer keeps the jack from slipping out of the leg. It is quickly and easily attached or removed by pulling the spring-loaded locking pin.

